

BY AUCTION

£165,000

4 Hayne Road

Beckenham, BR3 4XD

Ashton Court BECKENHAM BR3 4XD

Approximate Gross Internal Area
Main House = 46.5 SqM 500 sq.ft

1st Floor

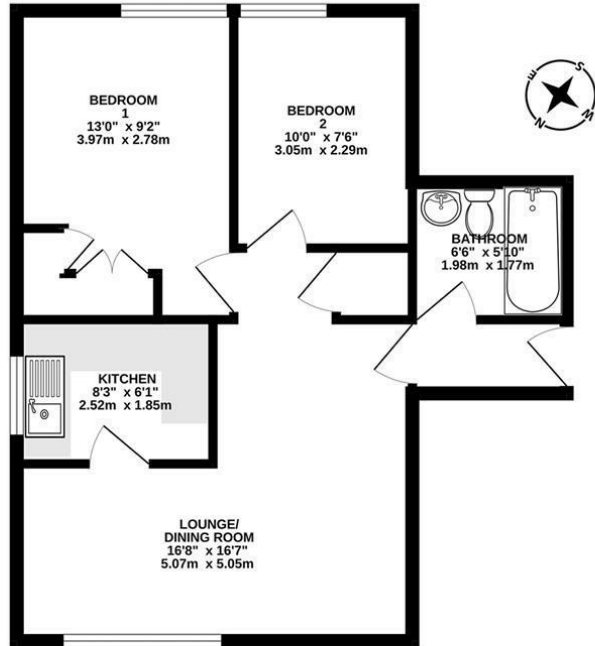

FOR ILLUSTRATIVE PURPOSES ONLY- NOT TO SCALE
The Position & size of doors, windows, appliances and other features are approximate only.

FOR ILLUSTRATIVE PURPOSES ONLY- NOT TO SCALE
The Position & size of doors, windows, appliances and other features are approximate only.

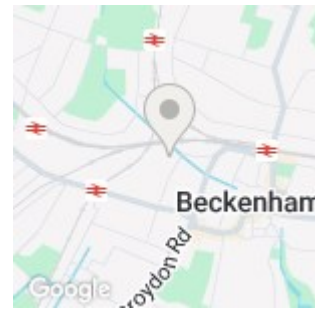

Energy Efficiency Rating		Current	Potential
Very energy efficient - lower running costs			
(92 plus)	A		
(81-91)	B		
(69-80)	C		
(55-68)	D		
(39-54)	E		
(21-38)	F		
(1-20)	G		
Not energy efficient - higher running costs			
England & Wales		75	79
EU Directive 2002/91/EC			



Agents Note: Whilst every care has been taken to prepare these particulars, they are for guidance purposes only. All measurements are approximate and are for general guidance purposes only and whilst every care has been taken to ensure their accuracy, they should not be relied upon and potential buyers/tenants are advised to recheck the measurements